

**GENERAL INFORMATION**

**TAPFAST®**

Metal-to-Wood Self-Drilling Screws

**PRODUCT DESCRIPTION**

TapFast fasteners are high-performance fasteners designed specifically for attaching light gauge metal panels (18 ga. maximum) to wood frame structures.

**GENERAL APPLICATIONS AND USES**

- Metal roofing and siding panels to wood

**FEATURES AND BENEFITS**

- + Aluminum EPDM bonded sealing washers provide a weather-tight seal
- + High-low thread increases performance
- + Easily penetrates multiple panel thicknesses
- + Fasteners coated with Stalgard typically show no red rust or other base metal corrosion on significant surfaces after 1000 hours of salt spray exposure in accordance with ASTM B117
- + Stalgard® coating provides improved corrosion resistance compared with fasteners with standard zinc plating

**GUIDE SPECIFICATIONS**

05 05 23 - Metal Fastenings, 06 05 23 - Wood, Plastic and Composite Fastenings, 09 22 16.23 - Fasteners. Fasteners shall be TapFast as supplied by DEWALT, Towson, MD. Fasteners shall be installed in accordance with published instructions and the Authority Having Jurisdiction.

**SECTION CONTENTS**

General Information..... 1  
 Material Specifications ..... 1  
 Installation Instructions ..... 1  
 Performance Data ..... 2  
 Ordering information ..... 2

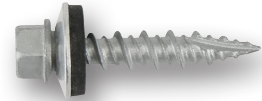

**MATERIALS**

- Carbon Steel

**HEAD STYLES**

- Hex Washer Head

**DIAMETERS**

- #10

**POINT TYPES**

- Type 17

**FINISH**

- Stalgard®

**MATERIAL SPECIFICATIONS**

Fastener Component	Specifications
Fastener Body and Head	Case hardened carbon steel
Washer	EPDM bonded to an aluminum alloy
Plating/Coating	Stalgard coating 1,000 hour rating in ASTM B117 salt spray test

**INSTALLATION INSTRUCTIONS**

**Installation Instruction**

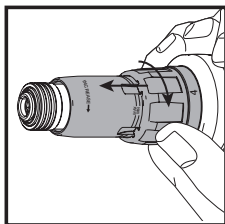

**Step 1**  
 Select a torque adjustable screwgun that align with the recommended installation RPM's of the particular fastener (DEWALT VersaClutch Screwguns are recommended). Adjust the setting on the screwgun so that the tool does not overdrive the fastener.

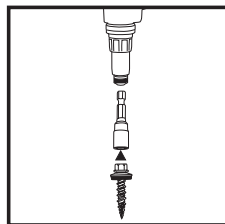

**Step 2**  
 Attach an appropriate sized hex nut driver to the screwgun. Mount the screw fastener head into the driver.

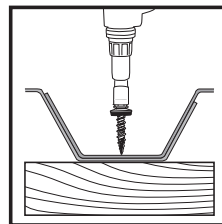

**Step 3**  
 Place the screw fastener against the work surface. While the screw fastener is in a perpendicular position, begin driving the screw fastener into the base material.

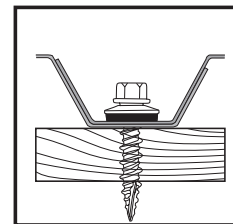

**Step 4**  
 Drive the screw fastener until the head is snug tight and the sealing washer is compressed against the metal panel.

Note: A trial installation is suggested to determine the optimal tool setting to ensure proper compression of the sealing washer.



**PERFORMANCE DATA**

**Pull-Out and Shear Capacity: Spuce, Pine or Fir (Minimum .38 Specific Gravity), lbf<sup>1</sup>**

Force Orientation relative to wood's grain	Edge Distance	Embedment					
		1"		1-1/2"		2"	
		Pull-Out	Shear	Pull-Out	Shear	Pull-Out	Shear
With The Grain (Into thin side)	3/4"	385	445	550	480	885	645
Against the grain (Into wide side)	1-1/2"	365	320	590	655	890	650

1. Performance data are ultimate loads based on laboratory tests.

**Pull-Out and Shear Capacity: Southern Yellow Pine , #2 Grade (Minimum .57 Specific Gravity), lbf<sup>1</sup>**

Force Orientation relative to wood's grain	Edge Distance	Embedment					
		1"		1-1/2"		2"	
		Pull-Out	Shear	Pull-Out	Shear	Pull-Out	Shear
With The Grain (Into thin side)	3/4"	1,115	780	1,645	885	1,945	935
Against the grain (Into wide side)	1-1/2"	1,220	660	1,570	685	1,805	720

1. Performance data are ultimate loads based on laboratory tests.

**ORDERING INFORMATION**

**TapFast®**

Cat. No.	Description (Diameter - TPI x Nominal Length)	Point Type	Finish	Nominal EPDM Washer Outer (in.)	Nominal Head Height (in.)	Qty / Carton	Qty / Case
<b>#10 DIAMETER, 1/4" HEX WASHER HEAD WITH ALUMINUM EPDM BONDED SEALING WASHER</b>							
DFSEHH210	#10 - 16 x 1"	TYPE 17	STALGARD®	0.500	0.295	3000	-
DFSEHH230	#10 - 16 x 1-1/2"	TYPE 17	STALGARD®	0.500	0.295	2500	-
DFSEHH250	#10 - 16 x 2"	TYPE 17	STALGARD®	0.500	0.295	1500	-
DFSEHH265	#10 - 16 x 2-1/2"	TYPE 17	STALGARD®	0.500	0.295	1000	-
DFSEHH280	#10 - 16 x 3"	TYPE 17	STALGARD®	0.500	0.295	800	-

1. Nominal Head Height includes the thickness of the Aluminum EPDM Bonded Sealing Washer before installation. This thickness will be slightly reduced when installed.

**Screwguns**

Cat. No.	Description	Screw Diameter
DW268	2,500 RPM VSR VERSA-CLUTCH™ Screwgun	#10
DCF622M2	20V MAX* XR® VERSA-CLUTCH™ Adjustable Torque Screwgun Kit	#10

\*For 20V MAX\* Maximum initial battery voltage measured without a workload is 20 volts. Nominal voltage is 18. TapFast Fasteners must be installed perpendicular to the work surface using a maximum 2500 RPM screw gun with a torque sensing nose piece. Impact tools are not recommended for the installation of TapFast fasteners.



**Accessories**

Cat. No.	Description
DWA2221IR	1/4" Impact Ready® Cleanable Nut Driver
DW2218IR	1/4" Impact Ready® Nut Driver



**SCREW FASTENERS**

**TAPFAST®**  
Metal-to-Wood Self-Drilling Screws